

SOLENOID ASSEMBLY

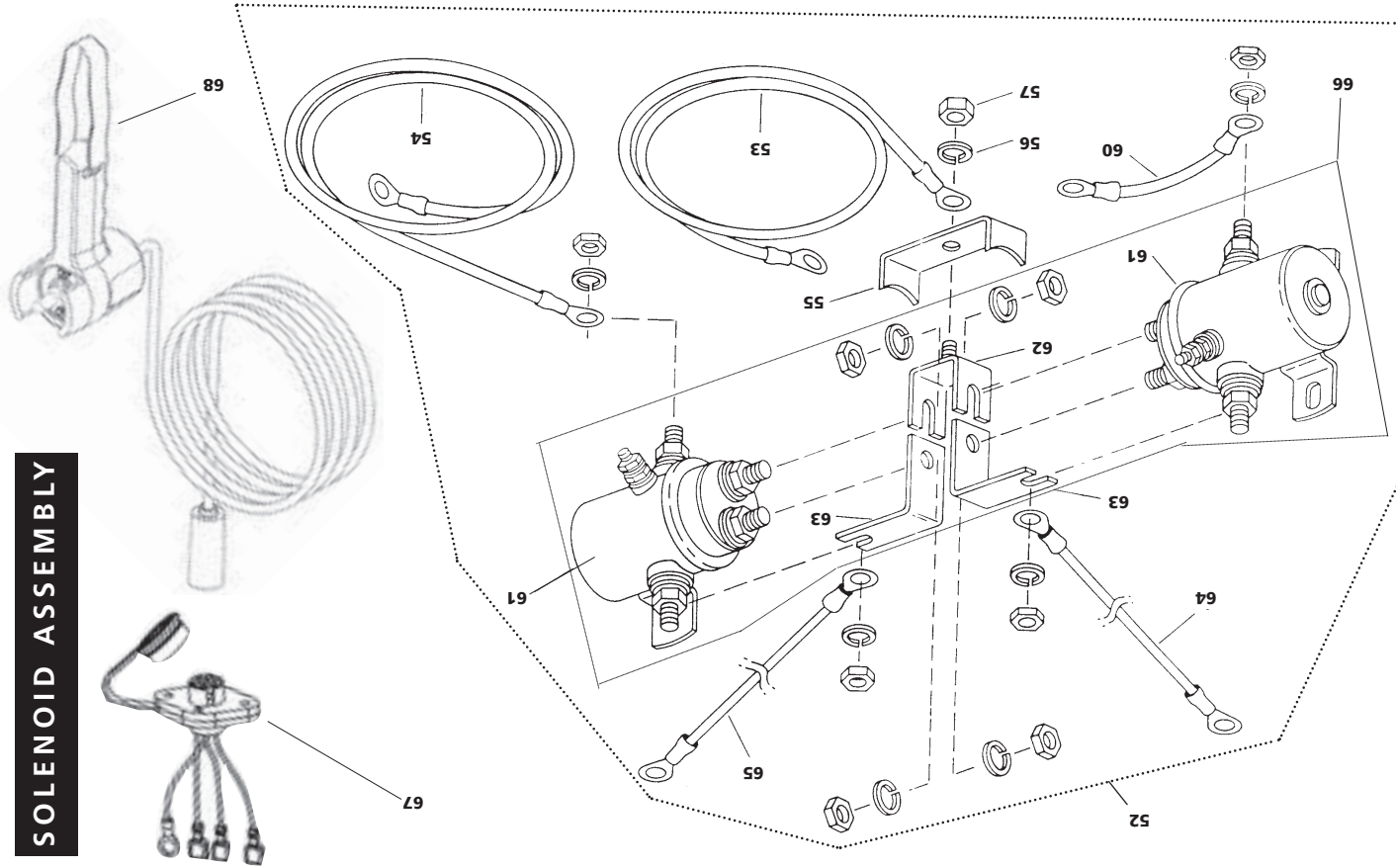

REPLACEMENT PARTS LIST

Reference Number	Description	Part Number	Qty
52	12V Wired Solenoid Assembly	89-32327	1
	24V Wired Solenoid Assembly	89-32328	1
53	S3000, S4000 8AWG x 5' (neg.) Leadwire Assy.	89-23306-01	1
	S5000 2AWG x 5' (pos.) Leadwire Assembly	89-22635-34	1
54	S3000, S4000 8AWG x 5' (pos.) Leadwire Assy.	89-23306-04	1
	S5000 6AWG x 5' (neg.) Leadwire Assembly.	90-20187-06	1
55	Ground Strap	89-23356	1
56	5/16 Hel Spring Lock Washer	89-23227-08	1
57	5/16-18 Hex Nut	90-23149-07	1
60	6AWG x 3 1/2" Leadwire Assembly	90-23292-06	1
61	12V Solenoid	90-20329	2
	24V Solenoid	90-20331	2
62	Buss Bar Assembly	92-10200	1
63	Buss Bar	92-20126	2
64	S3000, S4000 8AWG x 9 3/8" Leadwire Assy.	89-23292-21	1
	S5000 6AWG x 9 3/8" Leadwire Assembly	90-20187-08	1
65	S3000, S4000 8AWG x 6" Leadwire Assembly	89-23306-02	1
	S5000 6AWG x 6" Leadwire Assembly	89-23292-19	1
66	12V Solenoid Sub-Assembly	90-32250	1
	24V Solenoid Sub-Assembly	90-32250-01	1
67	Socket Half Connector	90-25048	1
68	Remote Control Assembly	90-40270-02	1
69	Safety Label. 3/4" icon, 3 x 2	89-20330	1

TORQUE SPECIFICATIONS

TORQUE SPECIFICATIONS

Drum Support Plate Screws	50-60 lb in
Hawse (Roller Fairlead) Screws	45-55 lb in
Base Screws	65-75 lb in
Motor	35-40 lb in

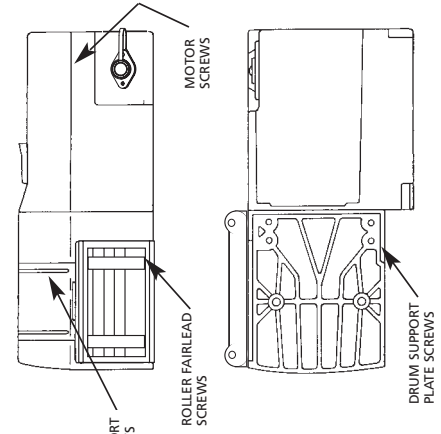

⚠ WARNING
Over torquing could damage your winch and void your warranty.